

<b>Car</b>	Toyota Supra A90 3.0T Non GPF (ROW)	<b>Part No.</b>	STYC012
<b>Year</b>	2019-Current	<b>Fit Kits</b>	386FK
<b>Notes</b>	Where not supplied use original fittings Vacuum blanking cap supplied for GPF models	<b>Features</b>	Pipe Diameter:- 125mm

Estimated Fitting Time: 1 Hour

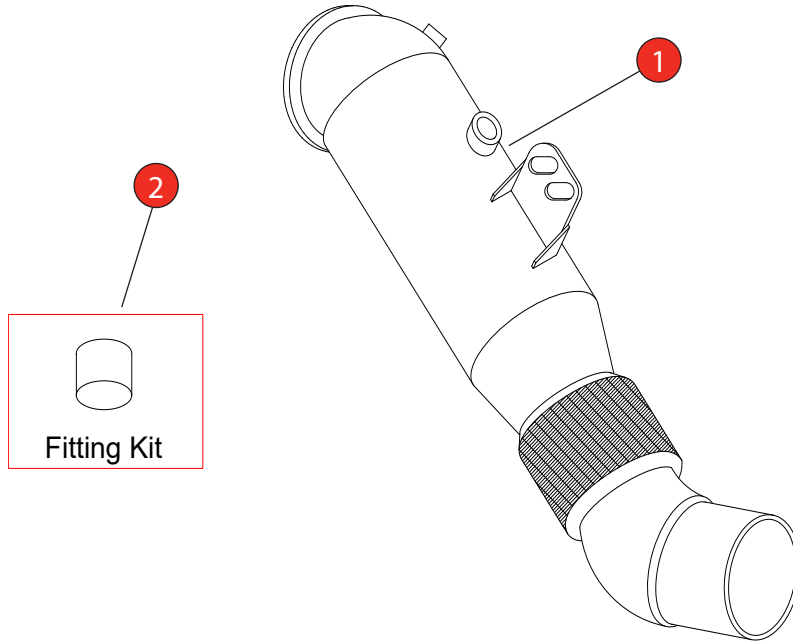

NO.	PART NO.	DESCRIPTION	QTY
1	937BM	De-Cat Downpipe	1
<b>Fit Kit</b>			
2	386FK	Black Silicone Vacuum Blanking Cap - 8mm	1

CLASSIFICATION	Motorsport Use Only
HOMOLOGATED	No
DATE	18/07/2024
ISSUE	00
AUTHORISED	G O'Shea

**NOTE:** ENSURE SCORPION SYSTEM IS CLEAR OF MOVING PARTS AND ALL ORIGINAL FUNCTIONS WORK CORRECTLY.



STAY CONNECTED TO RED POWER.

<b>Car</b>	Toyota Supra A90 3.0T Non GPF (ROW)	<b>Part No.</b>	STYC012
<b>Year</b>	2019-Current	<b>Fit Kits</b>	386FK
<b>Notes</b>	Where not supplied use original fittings Vacuum blanking cap supplied for GPF models	<b>Features</b>	Pipe Diameter:- 125mm

Estimated Fitting Time: 1 Hour 30

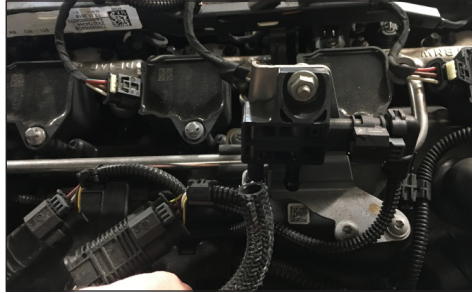

Blanking Cap Instructions  
 (GPF models only):

Locate the vacuum line running between the downpipe and the pressure sensor on the engine.

Remove the vacuum line from the sensor.

Push the blanking cap onto the sensor port that the vacuum pipe was on.



Gasket:  
 Remove the gasket from the original downpipe and re-install on the Scorpion downpipe

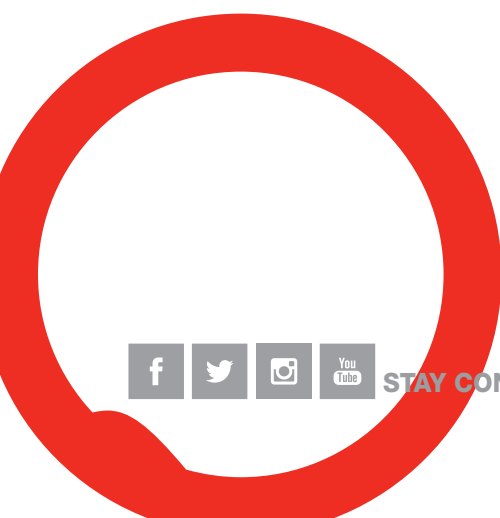

STAY CONNECTED TO RED POWER.